



EIW 20K ALUMINUM SHORING SYSTEM

Products and Services

Access Scaffolding Systems

- TSS Total Scaffold System (Steel/Aluminum)
- Total Frame Scaffold System (Aluminum)
- Traditional Frame Scaffolding

Shoring Systems

- Truss Shoring System (Steel/Aluminum)
- QSS Quick Strip System (Aluminum)
- HD Frame Shoring (Steel/Aluminum)
- Post Shores (Steel/Aluminum)

Forming System

- Panel Forming System (Steel/Aluminum)
- Mega Form Panel Forming System (Aluminum)
- Gang Forming System (Aluminum)
- Aluminum Beams
- Aluminum Strong Backs

Technical Services

- Project Analysis
- Technical Training
- On Site Technical Support
- Custom Design

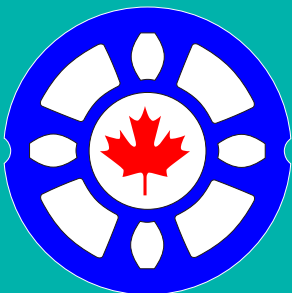

Etobicoke Ironworks Limited

141 Rivalda Road Weston Ontario M9M 2M7

Tel: (416) 742-7111

Fax: (416) 742-2737

email: info@eiw-ca.com

www.eiw-ca.com

COMPONENTS OF 20K FRAME SYSTEM

* FRAME WIDTH ALSO AVAILABLE IN 4' AND 5'

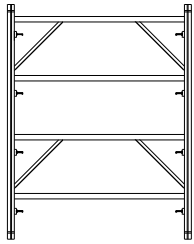

6' x 8' FRAME
Code no 226680
Weight 55 lbs (25 kg)

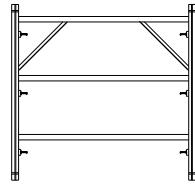

6' x 6' FRAME
Code no 226660
Weight 40 lbs (20 kg)

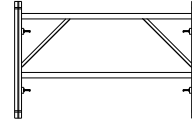

6' x 4' FRAME
Code no 226640
Weight 28 lbs (14 kg)

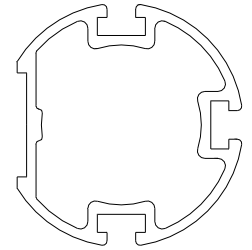

FRAME LEG PROFILE

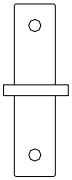

CONNECTOR
Code no 210200
Weight 2.19 lbs (1.0 kg)

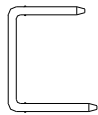

U-PIN

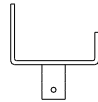

J-HEAD



BASE PLATE FOR FRAME LEG

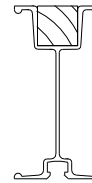

190 ALUMINUM BEAM



165 ALUMINUM BEAM

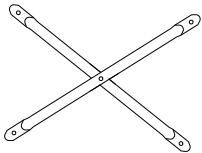

CROSS BRACE

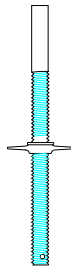

SCREWJACK

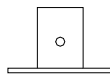

BASE PLATE FOR SCREWJACK



SHORE STAFF

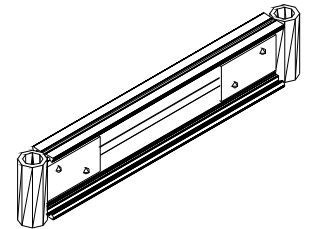

SADDLE BEAM

LOADING CHART

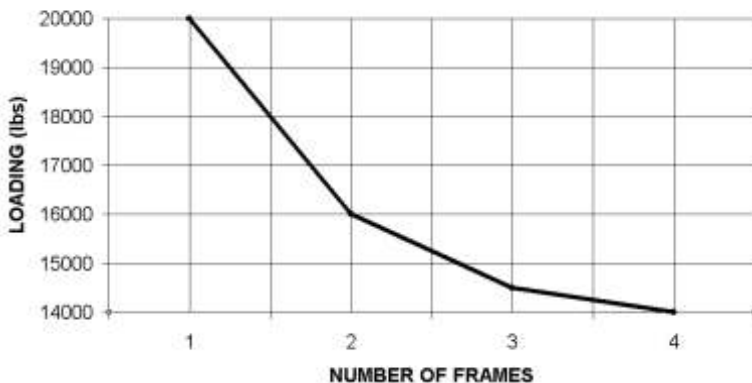

- The above allowable frame loads reflect a 3.0 to 1 safety factor
- The capacity is based on 12" (300 mm) top and bottom screw jack extension
- Horizontal bracing is required when the height exceed 3 times the width of the frame
- For conditions other than the above, consult EIW engineering department

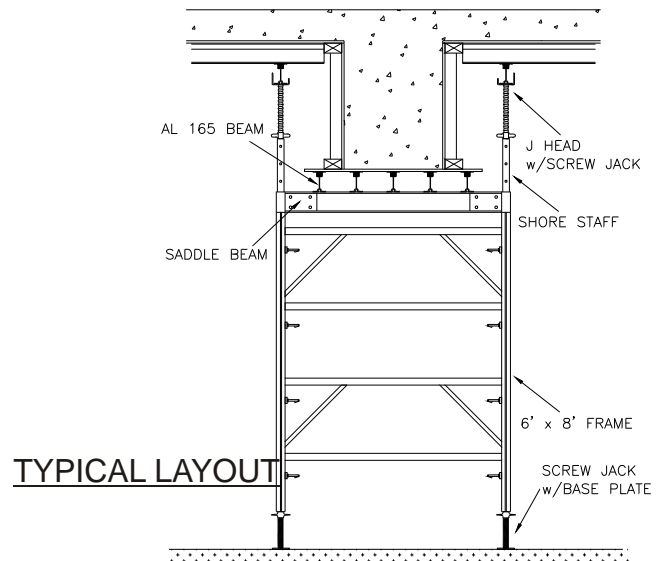

TYPICAL LAYOUT



Eticoke Ironworks Limited

141 Rivalda Road Weston Ontario M9M 2M7
Tel: (416) 742-7111 Fax: (416) 742-2737
email: info@eiw-ca.com www.eiw-ca.com

Distributed by: